



One Williams Center, OTC-8
Tulsa, OK 74172

**CEDAR TREE VILLAGE HOMEOWNERS
PO BOX 1438
BETTENDORF, IA 52722**

**RE: Notification of Pipeline Maintenance
Bettendorf Jct - Bettendorf #1-8IN
Scott County, Iowa
PROPERTY ID: T78N-R4E; SW15
Dig #: 180-4, Tract: 9034**

Dear Land Owner:

As you are probably aware, Magellan Pipeline Company operates a pipeline that crosses your property. Magellan will be accessing its easement on your property to perform pipeline maintenance within its existing right-of-way (ROW) for its interstate refined products pipeline facilities. The above-described Maintenance Work is anticipated to begin in the next few weeks.

You have been identified as a landowner that will be impacted by the Maintenance Work, either because your property will be directly affected by the Maintenance Work or your property will be crossed to access the Maintenance Work site. Please be assured Magellan strives to be a good neighbor. Magellan will exercise care to ensure that your property is not damaged and that all disturbed areas will be restored, as close as practical, to the condition that existed prior to the Maintenance Work being performed.

If you have a tenant on this property, please contact me with their information so we can inform them as well.

Please feel free to contact me with any questions or concerns regarding the Maintenance Work at 918-574-7157 or via email at Bryan.Ferguson@Magellanlp.com.

Sincerely,

A handwritten signature in black ink, appearing to read "Bryan Ferguson", written over a light blue horizontal line.

Bryan Ferguson
Sr. Real Estate Representative
Magellan Midstream Partners, L.P.

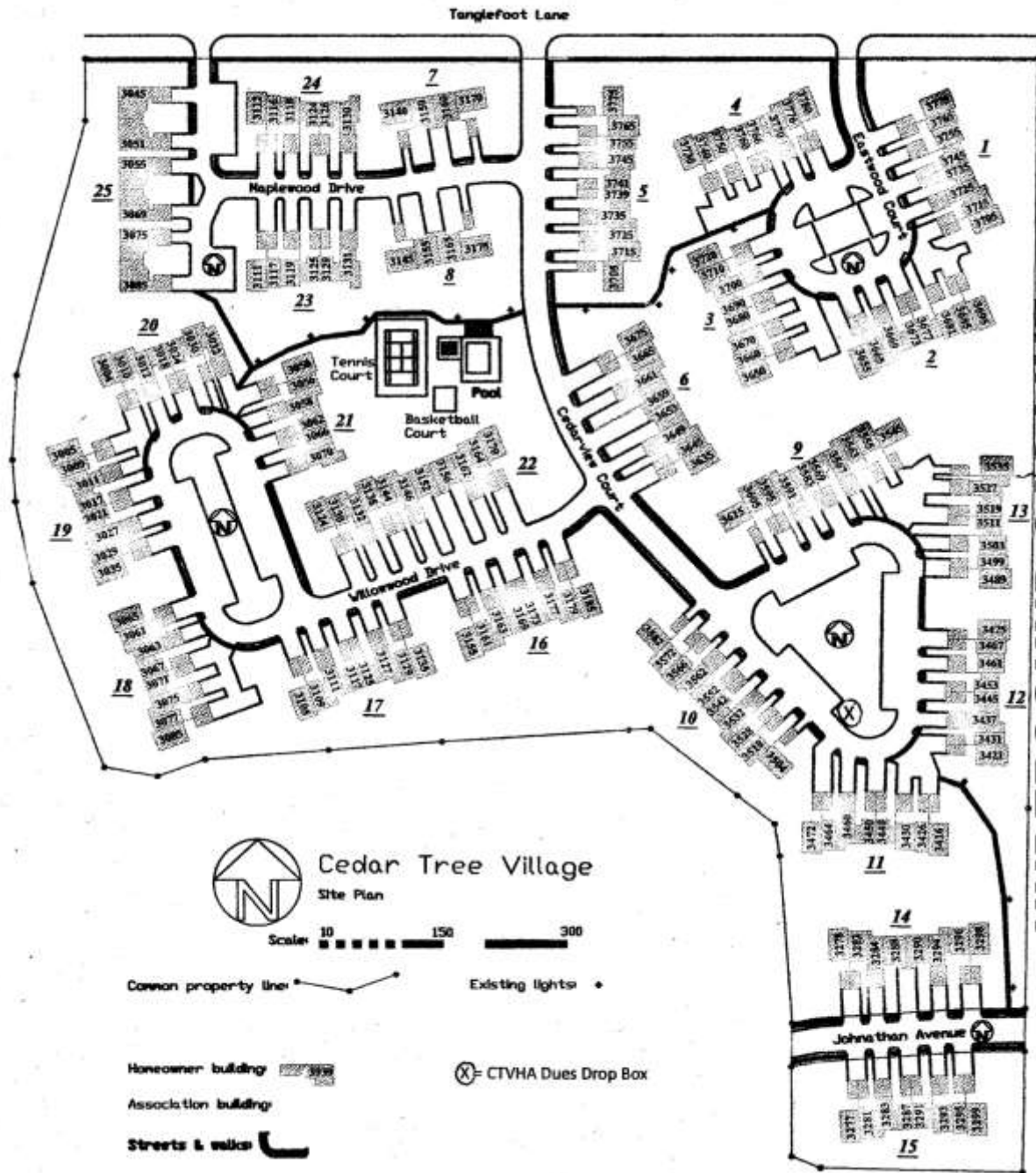

UNDERGROUND GAS LINE